

## Hinges with screw-covers

### Technopolymer

#### MATERIAL

Acetal resin based (POM) technopolymer, black colour, matte finish.

#### ROTATING PIN

Acetal based (POM) technopolymer, black colour.

#### SCREW-COVERS

Polyester based (PBT) technopolymer, black colour, matte finish, snap-in assembly.

#### STANDARD EXECUTIONS

- **CFQ-SH**: pass-through holes for countersunk head screws.
- **CFQ-CH**: pass-through holes for cylindrical head screws.
- **CFQ-EH**: pass-through holes for hexagonal head screws.

#### ROTATION ANGLE (APPROXIMATE VALUE)

Max 195° (-15° and +180° being 0° the condition where the interconnected surfaces are on the same plane).

Do not exceed the rotation angle limit so as not to prejudice the hinge mechanical performance.

To choose the convenient type and the right number of hinges for your application, see the Guidelines (on page 1368).



FMMdesign

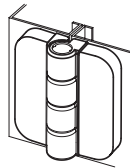
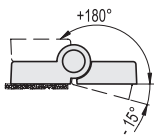

Resistance tests					
AXIAL STRESS		RADIAL STRESS		90° ANGLED STRESS	
Maximum working load Ea [N]	Load at breakage Ra [N]	Maximum working load Er [N]	Load at breakage Rr [N]	Maximum working load E90 [N]	Load at breakage R90 [N]
300	1220	350	1970	290	720

CFQ-SH

CFQ-CH

CFQ-EH

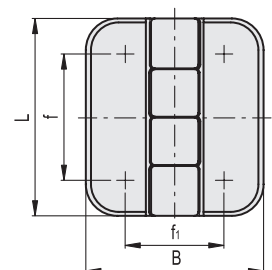
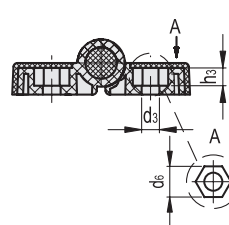
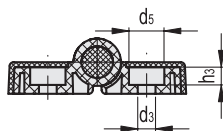
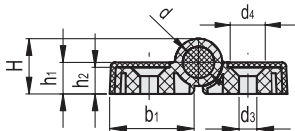

Code	Description	L	B	f	f1	H	h1	h2	h3	b1	d	d3	d4	d5	d6	C# [Nm]	⚠
426331-C9	CFQ.50 SH-4-C9	50	45	32	25	14	8	7	-	21.5	8	4.5	8.5	-	-	1.5	17
426332-C9	CFQ.50 CH-4-C9	50	45	32	25	14	8	7	4.5	21.5	8	4.5	-	8.5	-	1.5	17
426333-C9	CFQ.50 EH-4-C9	50	45	32	25	14	8	7	4.5	21.5	8	4.5	-	-	7	1.5	17

# Suggested tightening torque for assembly screws.